



ROXX E.Show PO-Yoke Assembly Instructions

Article N° 11905901

Included parts:



1 x PO-Yoke

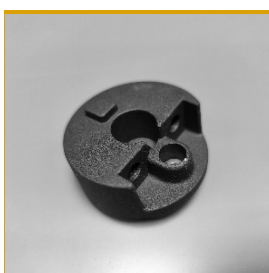

1 x Terminal A



1 x Terminal B

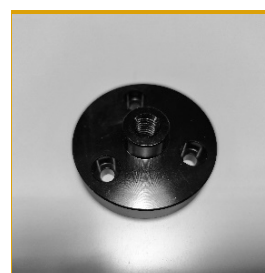

1 x Terminal C



6 x Screw D

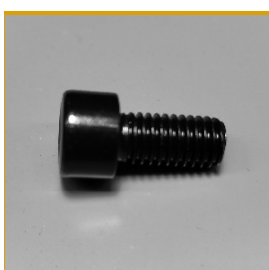

1 x Screw E

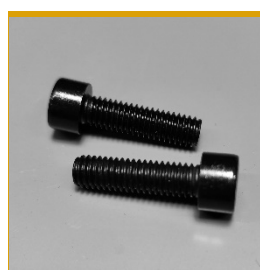

2 x Screw F

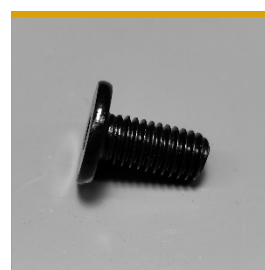

1 x Screw G



1 x Washer H

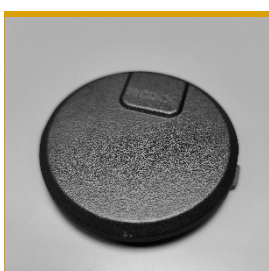

1 x Cap I

1. Remove the Standard Yoke from the E.Show.
Dismount the Yoke Mounting Bases on both sides.



2. Mount Terminal A to the side the pole operating bells should be located in the end. Use 1 x screw D and 1 x screw E.



3. Mount Terminal B to the other side of the fixture using 2 x screw D.

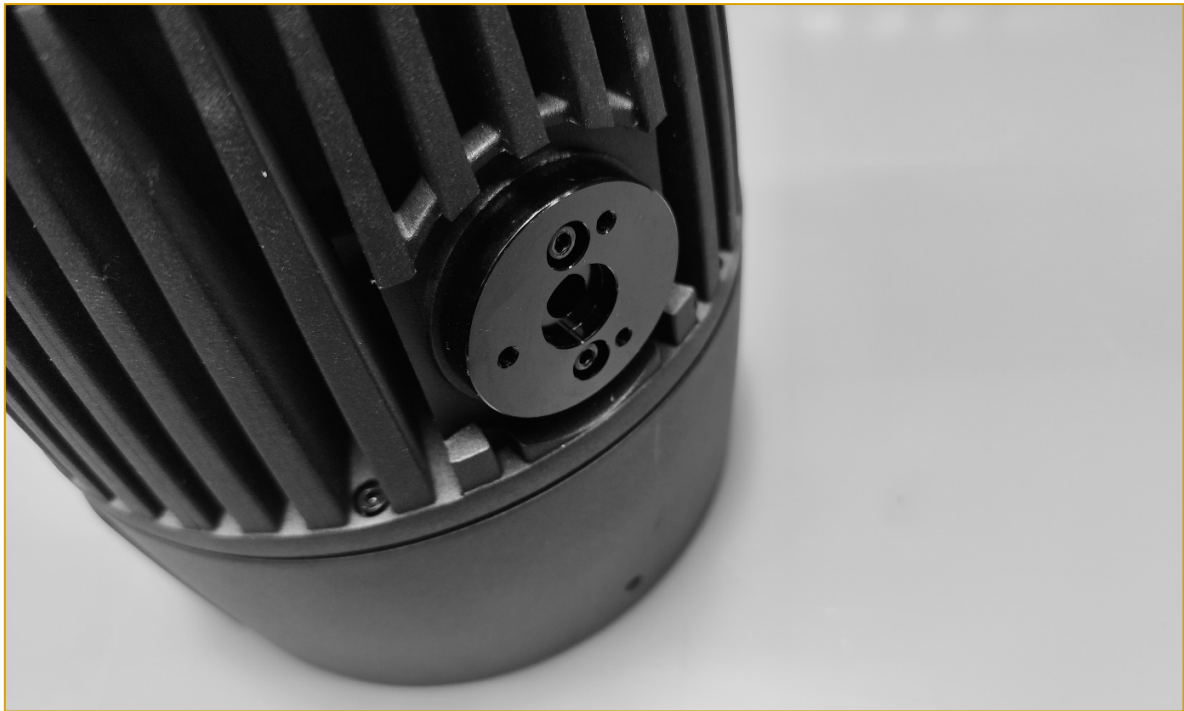

4. Mount Terminal C onto Terminal B using 3 x screw D.



5. Attach now the PO-Yoke to Terminal A using 2 x screw F.



6. Fasten now the other side of the PO-Yoke to Terminal C.
Use screw G including washer H, screw in carefully.



7. Attach sealing Cap I.



Important Safety Information

- Use this accessory only with suitable and approved hanging equipment. Don't use the equipment for any other intended purpose or manner.
- Make sure the device is securely installed and cannot fall.
- Check all connections periodically on tightness.
- Always check and follow the local safety regulations applying for your country before and during installation.